

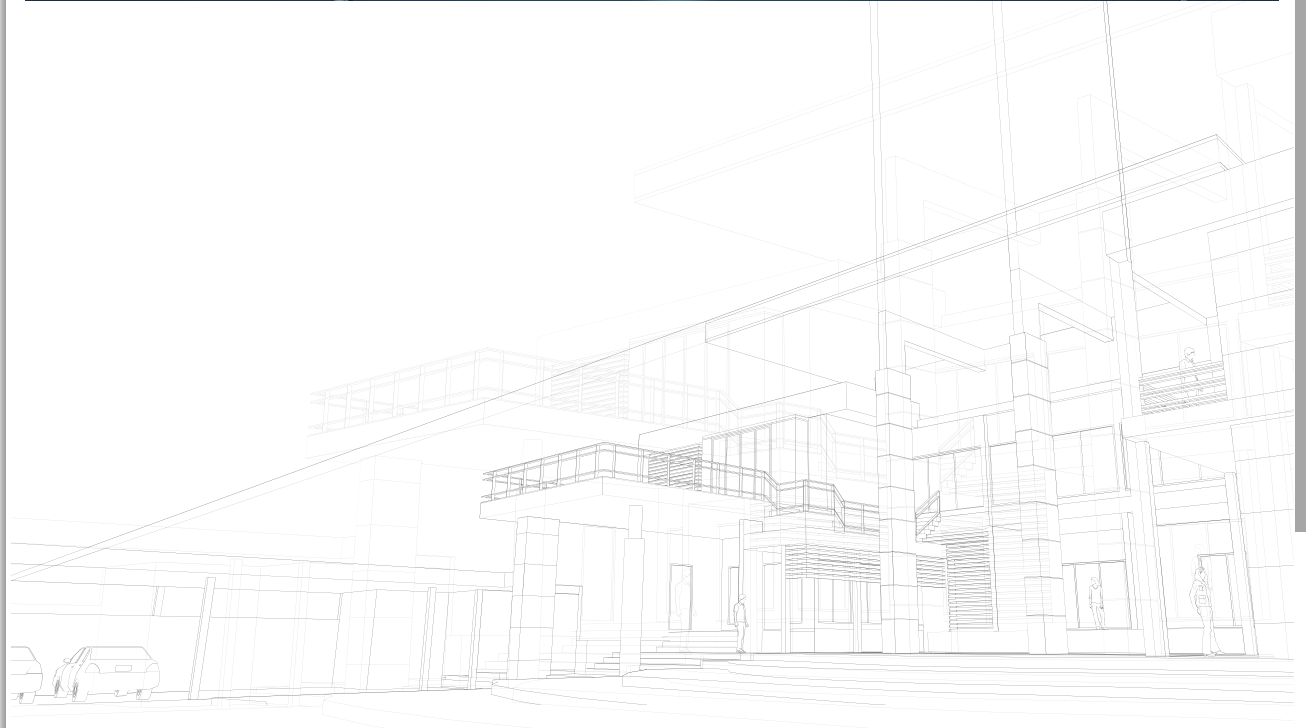

# Corporate Associates Presidential Group (CAPG) Activities

*Date: November 26, 2025*



# Meeting Agenda

1. CAPG **Logo – CA Survey Results**
2. CA dedicated **Webpage** at ISSMGE.org
3. CA Joining **Online Enrolment & Pay Page**
4. CA Articles/papers at **ISSMGE Bulletin**
5. CA Commercial Ads at **ISSMGE Bulletin**
6. CA shared **News at ISSMGE.org and GeoEngineer**
7. Briefing on CAPG sessions held at **Geotech Asia 2025** (7–10 October)
8. CA Contribution for **HTC**
9. CA session at ICSMGE **Vienna 2026** (Selected CAs)
10. CAPG **LinkedIn Official Page** is now live
11. CAPG Growth – **Marketing Campaign**

**CAPG Logo**

## CAPG Logo Survey



## Logo Survey Results

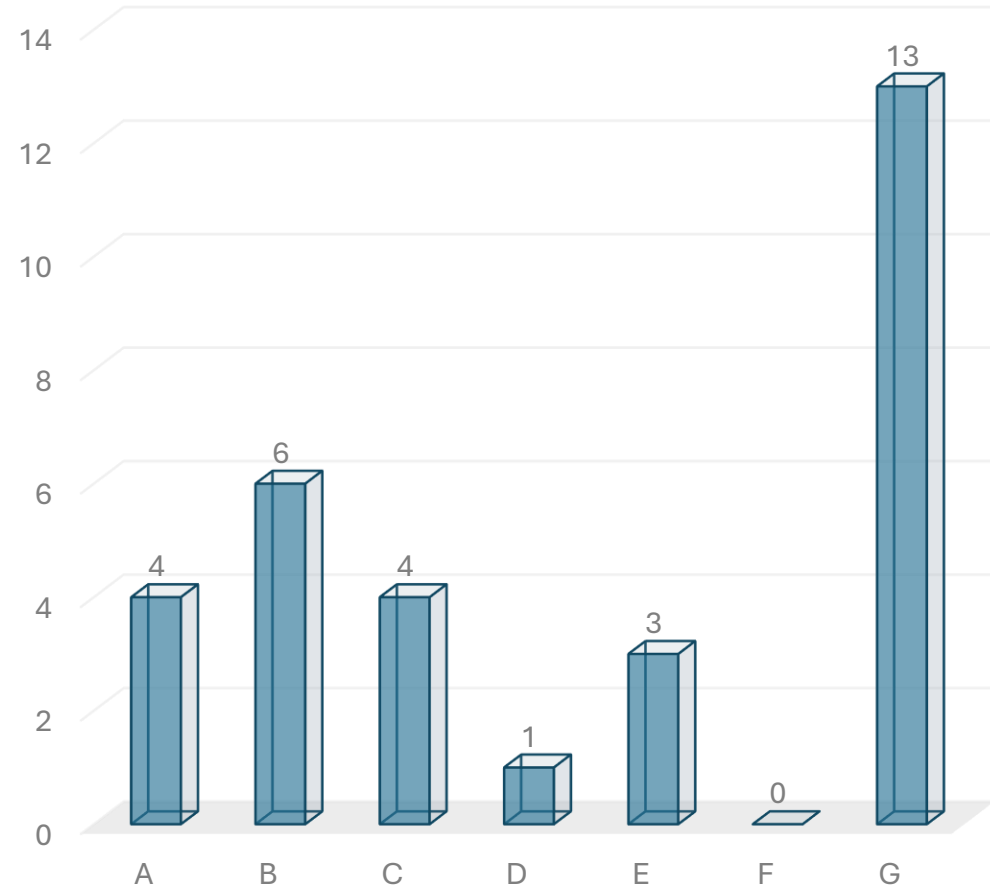
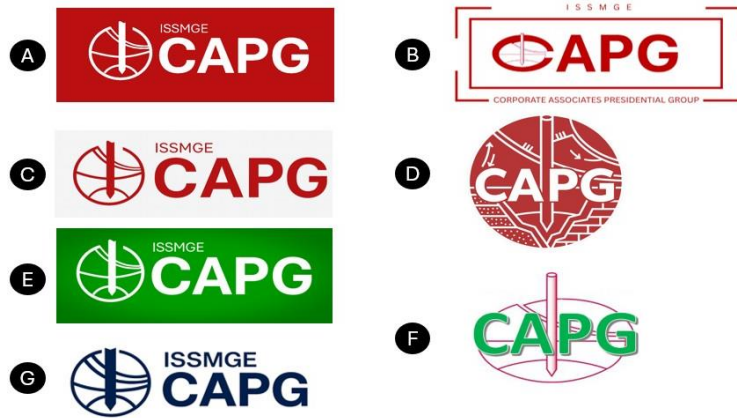

CAPG  
Logo



**CAPG Website**

## CA Webpage

**CAPG member is granted a webpage dedicated exclusively to their company**

[Corporate Associates | ISSMGE](#)

- **Feature 1: Company Services Overview**

A dedicated [webpage](#) on the ISSMGE website to showcase services, share unique experiences, and promote contributions to ISSMGE.

- **Feature 2: Company Official Website Link and Logo**

A prominent placement of CA organization's website and logo featured prominently on the dedicated webpage.

- **Feature 3: An Exclusive Company Showcase Feature For Platinum and Journal Sponsors**

Members to publish one advertisement document (brochure/flyer/video/image/presentation) that users can see and download. Example: [Dar Al-Handasah Consultants | ISSMGE](#)

**38** members out of **53** activated their own webpage

**We are following up closely with the remaining 15 members**



**Content from the remaining 15 Corporate Associates is still pending:**

1. CCC Fourth Harbor Engineering Institute Co Ltd
2. GHD Pty Ltd
3. Ground Investigation Ltd
4. International IGM
5. Keller Group PLC
6. KGS Ltd (geostroi)
7. RCF Ltd
8. Rocscience Inc
9. Shanghai Geoharbour Construction Group
10. Teclab Limited
11. Tencate Geosynthetics France SAS
12. A.P. van den Berg
13. Vattenfall Vindkraft A/S
14. Myrtle Project and Consultancy Private Limited – MPAC
15. SGES (New Corporate Associate)

## CAPG Webpage

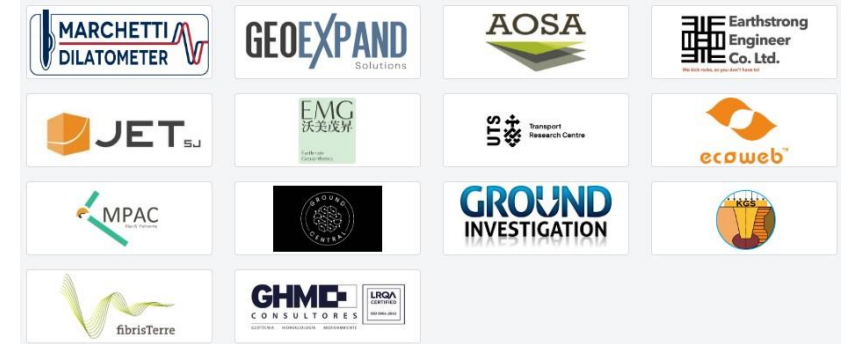

Corporate Associates | ISSMGE

# **CAPG Online enrolment**

*As quick as it can be!*

# Joining CAPG

Sign-up to receive committee news

[Main](#)[Members](#)[News/Updates](#)[Activities](#)[Archives](#)[Joining CAPG](#)[Contact](#)

## JOINING CAPG

ISSMGE IT Administrator | Corporate Associates | 12-06-2025

A number of companies and organisations are associated with the ISSMGE as corporate associates. Their commitment to the Society is of immense value and their financial contributions support non-administrative activities including education, the Young Geotechnical Engineers Conferences, technology transfer and lecture tours.

For more details on the Corporate Associate scheme, please click on the links below

### [ISSMGE Corporate Associate Invitation Letter](#)

To become a Corporate Associate, download and complete the one page [CAPG Application Form](#) or alternatively register online by accessing the [CAPG Membership Enrollment and Payment Portal](#) or scanning the QR code below.



[Joining CAPG | ISSMGE](#)

# CAPG Online Payment

## CAPG Membership Enrollment and Payment Portal

[Home](#) / [Corporate Associates](#)  
/ [CAPG Membership Enrollment and Payment Portal](#)

Be part of a global network of leading organizations in geotechnical engineering. CAPG offers structured membership categories to match your organization's size and engagement level.

Membership fees are categorized into three levels: Silver, Gold, and Platinum. To complete your registration, click the payment link corresponding to the level of your membership on the table below:

*Payments are processed securely via credit/debit card. You will receive a confirmation email upon successful transaction. A default payment amount is preset for each membership category, with the flexibility for members to change the amount and contribute additional funds at their discretion.*

SILVER	GOLD	PLATINUM
500 \$	1,500 \$	3,500 \$
Small enterprise (<20 employees)	Medium to large enterprise (20+ employees)	Medium to large enterprise (20+ employees)
Standard membership (Annual fee of \$1,500)	Standard membership (Annual fee of \$1,500)	Standard membership (Annual fee of \$1,500)
— \$1,000 rebate		\$2,000 sponsorship of ISSMGE activity + (Online library, Conference support, Awards, Website, ISSMGE bulletin or Webinars)
<a href="#">Pay Now</a>	<a href="#">Pay Now</a>	<a href="#">Pay Now</a>

or scanning the  
QR code below.



[CAPG Membership Enrollment and Payment Portal | ISSMGE](#)

# **CAPG Activities**

**CAPG @ Geo Asia**

# Briefing on Geotech Asia 2025 (7–10 October)

## Reimagining the Boundaries of our Profession



### Objective

To connect the past, present, and future of geotechnical engineering by highlighting legacy, challenges, and innovation.



### Who Should Attend?

Corporate associates, Engineers, Researchers, Academicians, Students & ISSMGE members

### Panellists



**Yuli Doulala-Rigby**  
Vice Chair, BGA.  
Development & Chief  
Civil Engineer, Tensar



**Walter Paniagua**  
ISSMGE VP (North  
America), Founder and  
CEO of PILOTEC



**Ricardo Justiniano**  
Civil Engineer, JETsj  
Geotechia Lda



**Ravikiran Vaidya**  
Principal Engineer &  
Director, Geo Dynamics



**Ashish Gharpure**  
Managing Director, Genstru  
Consultants Pvt. Ltd.



**Ritvik Bhalla**  
Chief Growth Officer,  
Encardio Rite Group

### Moderators



**Dr. Neelima Satyam**  
Professor, IIT Indore



**Dr. Hugo Acosta-Martinez**  
Technical Director, WSP Australia



neelima.satyam@iiti.ac.in,  
h.e.acosta@outlook.com  
+91-9440488034

Taj Cidade de Goa Horizon, Goa

Venue: All Day All Night  
Date: 10<sup>th</sup> October 2025  
Time: 2:00 PM - 3:30 PM



**International Society for Soil Mechanics and Geotechnical Engineering (ISSMGE)**



**Heritage Time Capsule (HTC) Project**

**Geotech Asia 2025 Combined ISSMGE CAPG & HTC Session**

**Geotechnical industry footprint: reimagining the boundaries of our profession**

HTC Contributions from Corporate Associates, Key insights and lessons learned from HTC Asia podcasts and panel discussion

Participants:

**ISSMGE Corporate Associate Representatives and India Industry Representatives:** TBC

**Session Leads:** Prof Neelima Satyam (Indian Institute of Technology Indore) and Dr Hugo Acosta-Martinez (WSP Australia)

**Day-in Day-out Room**  
Friday 10 October 2025, 2:00 to 3:30 pm

Kindly supported by:



*Thanks to  
Hugo Acosta (WSP)*



**CAPG @ HTC**

## Heritage Time Capsule (HTC)

- CAPG members are warmly invited to contribute to the **Heritage Time Capsule project**.
- At this date, we have several contributions published on the ISSMGE's website at the following path:  
<https://htc.issmge.org>
- Corporate Associates (CAs) have their online HTC contributions on the dedicated HTC website:  
[Contributions | ISSMGE: Heritage Time Capsule \(HTC\) Project](#)

**CAPG @ Vienna 2026**

## 21<sup>st</sup> ICSMGE in Vienna (June 2026)

**CAPG will host a dedicated 30-minute session showcasing Outstanding Geotechnical Projects. This session will feature 5 to 6 selected presentations, each approximately 5 minutes in length.**

### **Preparation Timeline:**

**Stage 1 – Call for Contributions (June 2025):** *Corporate Associates (CAs) interested in presenting are invited to contact the CAPG Chair directly. Submissions should include a brief description of the proposed project and highlight key elements demonstrating excellence in:*

- ✓ *Innovation*
- ✓ *Sustainability*
- ✓ *Advancements in geotechnical engineering practice*

**Stage 2 – Jury Formation (June–August 2025):** *A selection committee will be established to review and evaluate submissions. The jury will consist of at least six members, either official CAPG representatives or nominated delegates from CA member companies. This committee will oversee the voting process and secure the review of the proposed presentations.*

**Stage 3 – Evaluation (September 2025):** *Projects will be assessed based on:*

- ✓ *Innovation*
- ✓ *Sustainability*
- ✓ *Addressed challenges*
- ✓ *Additional criteria to be defined by the jury*

**Stage 4 – Announcement (October 2025):** *Selected projects will be officially announced in October 2025 and CA members will be requested to prepare their presentations.*

**Stage 5 – Presentation Development (November 2025 – February 2026):** *Selected CAs will prepare their presentations. A draft version should be submitted by December 2025 for review and feedback. Final presentations must be completed by February 2026.*

**Stage 6 – Presentation at ICSMGE (June 2026):** *The selected projects will be presented live during the Vienna conference. Additional high-quality submissions may also be featured on the CAPG section of the ISSMGE website, providing extended visibility for CA member contributions.*

**5 CAs** who have submitted their proposals:

- 1- GDS
- 2- Huesker
- 3- Menard
- 4- UTS
- 5- Tensar

**Selected projects are invited to prepare and submit their presentations in December for review and feedback.**

# **CAPG @ Bulletin**

## Papers at ISSMGE Bulletin

- An invitation was sent to the Corporate Associates for contribution in the upcoming **ISSMGE Bulletin** editions [ISSMGE Bulletin | ISSMGE](#) , a distinguished platform offering all Corporate Associate members the opportunity to showcase their notable, world-class projects to the global geotechnical community.
- The ISSMGE [Bulletin](#) is published quarterly (January, March, June, and September).  
*The latest issue, [Vol 19, Issue 3, September 2025](#)*
- Each Corporate Associate can submit a small article (**1–3 pages**) about a project case study or a research highlight that illustrates latest innovation, promotes sustainability in geotechnical engineering, and inspires young geotechnical engineers about the industry's best practice. Submissions should be engaging, avoiding overly technical or confidential content and may include visuals, hyperlinks, QR codes, or video links to enrich the narrative.
- Featured in the ISSMGE [Bulletin](#), these contributions offer prominent visibility and foster knowledge exchange within the global geotechnical community.
- Submission to the Bulletin will be sent to the editorial team for publication.

## Papers at ISSMGE Bulletin

### **Invitation for contributions (1–3 A4 pages, including photos) to the ISSMGE Bulletin**

Open to all members, regardless of membership

**Submitted Articles :** So far, **2** CA member have submitted their articles and are published in Vol 19, Issue 3, September 2025 | ISSMGE

**1- Geoquest**

**2- Wagstaff Piling**

*Should your company wish to take advantage of this opportunity, kindly share your documents with us for consideration in an upcoming issue of the Bulletin.*



## ISSMGE Bulletin Commercial Ads

A dedicated promotional page in the **ISSMGE Bulletin** for the Corporate Associates company's advertisements provided at no cost and at reasonable intervals (**Once or Twice per year**).

**Advertisement Allocation:** Each ISSMGE Bulletin edition will feature a total of **6 pages** of advertisements for CA members, allocated as follows:

- **1 page:** Platinum or Gold Journal Sponsor (with Priority to Platinum)
- **4 pages:** Gold Members
- **1 page:** Silver Members

### **ISSMGE Bulletin Advertisement Categories and Details:**

- **Platinum Member [1 member]**
  - **Ad Type:** Full-page
  - **Placement:** Priority; 1<sup>st</sup> back cover page (between pages 1 and 2); Reserved for Platinum
  - **Frequency:** Once per year
- **Gold Journal Sponsor Members [2 members]**
  - **Ad Type:** Full-page
  - **Placement:** 1st back cover page (between pages 1 and 2); 2<sup>nd</sup> in the priority sequence
  - **Frequency:** Once per year

## ISSMGE Bulletin Commercial Ads

### ➤ Gold Members [36 members]

- **Ad Type:** Half-page
- **Placement:** High-priority internal pages
  1. Between “President’s Desk Report” and “Vice President’s Report”(double-page)
  2. Between “From the Board” and “ISSMGE Highlights”(double-page)
  3. *Between “Global News Member Societies” and “Young Member Area”*
  4. *Between “Corporate Activities” and “Technical Committee Activities”*
- **Frequency:** Once per year

### ➤ Silver Members [14 members]

- **Ad Type:** Quarter-page
- **Placement:** as per below
  - Between “Global News Member Societies” and “Young Member Area”
  - *Between “Corporate Activities” and “Technical Committee Activities”*
- **Frequency:** Once per year

lish advertisement annually, free of charge, in line with the technical guidelines (refer to

So far, **10 Corporate Associates Members** have submitted **CA Ads** in Vol 19, Issue 3, September 2025 | ISSMGE.

1. Aurecon
2. fibrisTerre Systems GmbH
3. Gamuda (Australia) Branch
4. Huesker Synthetic GMBH
5. Jan De Nul N.V.
6. Seequent/Bentley
7. Smec Australia Pty Ltd
8. SRK Consulting Argentina S.A.
9. Wagstaff Piling
10. Ground Central PTY LTD

**CAPG @ News**

## ISSMGE CAPG “News” Activated

- The CAPG activities is now reflected on the News TAB [News | ISSMGE](#)
- The latest News will be periodically posted on ISSMGE.ORG and will be also reflected at the Geoworld platform reaching promptly to 1200+ members (those following CAPG)
- Corporate Associate members are encouraged to share updates on the CAPG dedicated webpage under [News | ISSMGE](#)

**CAPG @ LinkedIn**

## CAPG LinkedIn Page

The **CAPG LinkedIn Page** is now official!

We warmly invite all our valued Corporate Associates **to follow and like our page** [CAPG LinkedIn](#) to stay connected with the latest updates, insights, and initiatives from CAPG.

***An email has been shared with all Corporate Associates to follow and like CAPG official LinkedIn.***

*Please Follow us!*



### ISSMGE Corporate Associate Presidential Group (CAPG)

Engineering Services

Connecting geotechnical industry leaders to advance innovation, collaboration, and global best practices.

Follow

#### About us

The Corporate Associate Presidential Group (CAPG) was founded in 2011 under the initiative of ISSMGE President Prof. Jean-Louis Briaud. Since its inception, CAPG has become the dedicated platform within ISSMGE that connects corporate associates, practitioners, and academics to advance geotechnical engineering worldwide. Our mission is to foster collaboration between industry and academia, promote technical excellence, and ensure the latest research is translated into practical applications that benefit infrastructure development and society. CAPG provides a unique forum where geotechnical professionals can share experiences, exchange knowledge, and highlight innovation in the field. What we do: - Organize panel discussions, workshops, and surveys on critical geotechnical issues (e.g., overdesign, sustainability, innovations). - Facilitate participation in international conferences and ISSMGE initiatives such as the Virtual Time Capsule and the Heritage Time Capsule. - Offer Corporate Associates the opportunity to present their expertise, showcase outstanding projects, and engage directly with global leaders in the profession. - Support technical platforms that drive innovation and address pressing challenges in geotechnical engineering. Member Benefits: - Visibility through ISSMGE's website, Bulletin, and Journal of Case History. - Opportunities to present and publish technical insights and project highlights. - Networking with leading experts, companies, and academics worldwide. - Active involvement in shaping the direction of the geotechnical industry. Our Vision: To strengthen the global geotechnical community by bridging the gap between research and practice, promoting innovation, and recognizing the valuable contributions of our members.

Website	<a href="https://www.issmge.org/corporate-associates/corporate-associates-presidential-group">https://www.issmge.org/corporate-associates/corporate-associates-presidential-group</a>
Industry	Engineering Services
Company size	51-200 employees
Type	Nonprofit



# CAPG Marketing Campaign

*It started 1 week ago!*



## CAPG Marketing Campaign

**We are yet to launch the CAPG Marketing Campaign to expand the Corporate Associates community.**

- The website is set and ready; [Corporate Associates Presidential Group | ISSMGE](#)
- CA Members have well defined benefits  [Discover Full Details & Exclusive Benefits](#)
- Payment can be done online  [Register Online](#) or Corporate Associate can **scan the QR code below** to start the application process:



- The campaign will be launched through multiple channels:
  - \* **National Societies** (90)
  - \* **Companies registered at GeoEngineer database** (>1000)
  - \* Direct contacts (200+)
  - \* Social Media (**LinkedIn**)

## CAPG Marketing Campaign

International Society for Soil Mechanics and  
Geotechnical Engineering

Société Internationale de Mécanique des  
Sols et de la Géotechnique



Dear **National Society Representative (add society name),**

We kindly ask for your support in sharing an exclusive opportunity with companies in your network to become part of the **Corporate Associates Presidential Group (CAPG)** of the **International Society for Soil Mechanics and Geotechnical Engineering (ISSMGE)** — a global platform for industry leaders in geotechnical engineering.

Joining CAPG gives companies direct access to the international geotechnical community and the opportunity to actively shape the future of the profession.

 [Discover Full Details & Exclusive Benefits](#) **(link to web page that represents the letter)**

 [Download CAPG Application Form](#)

 [Register Online](#)

 Or simply scan the QR code below to apply:



# CAPG Marketing Campaign

**International Society for Soil Mechanics and  
Geotechnical Engineering**

**Société Internationale de Mécanique des  
Sols et de la Géotechnique**



Dear [Name],

We are pleased to extend a personal invitation to your organization to join the **Corporate Associates Presidential Group (CAPG)** of the **International Society for Soil Mechanics and Geotechnical Engineering (ISSMGE)** — a global platform for industry leaders in geotechnical engineering.

As a **Corporate Associate**, your company can:

- 🏢 Engage in board-level industry discussions
- 📊 Showcase flagship projects at international events
- 📄 Gain visibility in ISSMGE publications and platforms
- 🔗 Access exclusive networking opportunities and technical content

🌐 [Discover Full Details & Exclusive Benefits](#) (link to web page that represents the letter)

📄 **How to Join**

- ♦ [Download CAPG Application Form](#)
- ♦ [Register Online](#)
- ♦ Or simply scan the QR code below to apply:



## CAPG Marketing Campaign Video

- We are launching a campaign aimed at growing our **Corporate Associates members**.
- This initiative will not only strengthen our community today but will also leave a lasting imprint, benefiting future generations.

### The Corporate Associates Presidential Group **CAPG**





