

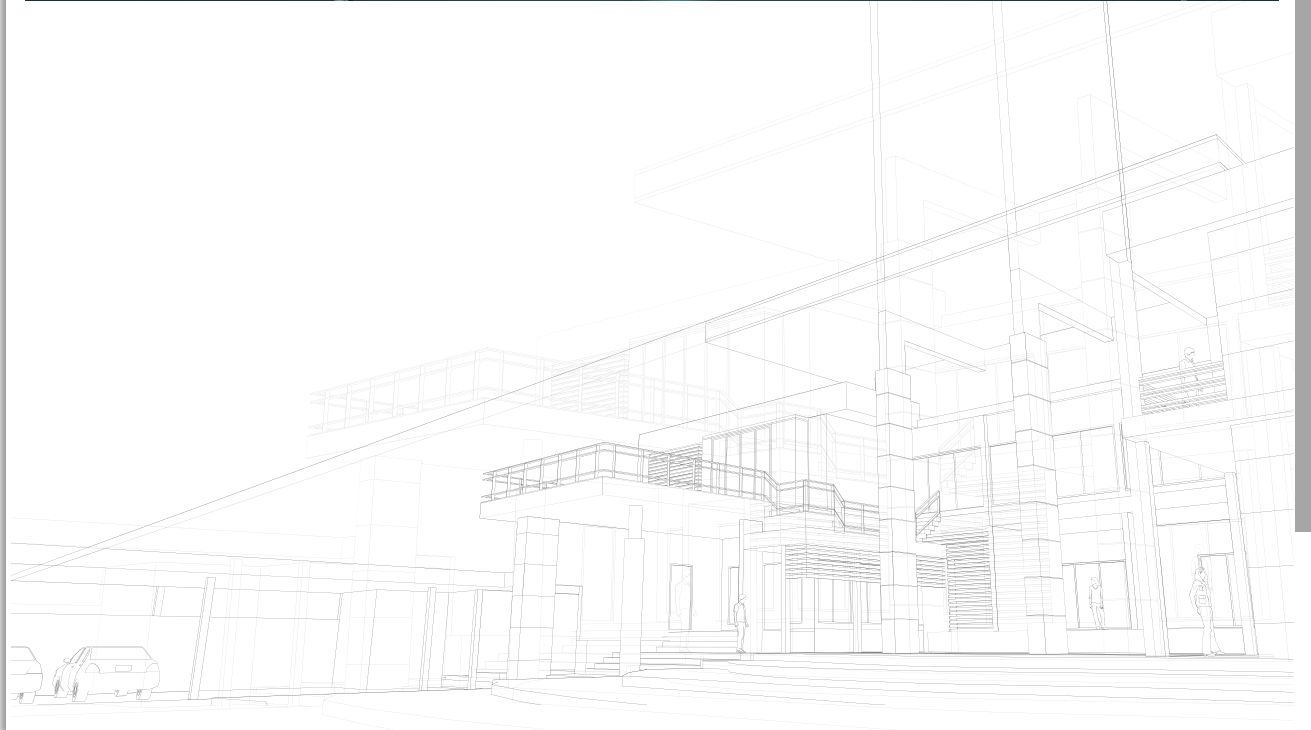

# Corporate Associates Presidential Group (CAPG) Activities

*Date: January 28, 2026*



# Meeting Agenda

1. CAPG [LinkedIn](#) Official Page!
2. CAPG Invitation to [PMGEC 2026 – Lebanon](#)
3. CAPG Growth – Marketing Campaign
4. CAPG session at [ICSMGE 2026](#), Vienna
5. CAPG Contribution to the ISSMGE Heritage Time Capsule ([HTC](#)) @ICSMGE

**CAPG @ LinkedIn**

## CAPG LinkedIn Page

The **CAPG LinkedIn Page** is now official and Active!

Corporate Associates were invited **to follow and like our page [CAPG LinkedIn](#)** to stay connected with the latest updates, insights, and initiatives from CAPG.

***An email has been shared with [all Corporate Associates](#) inviting them to follow and like CAPG official LinkedIn page.***

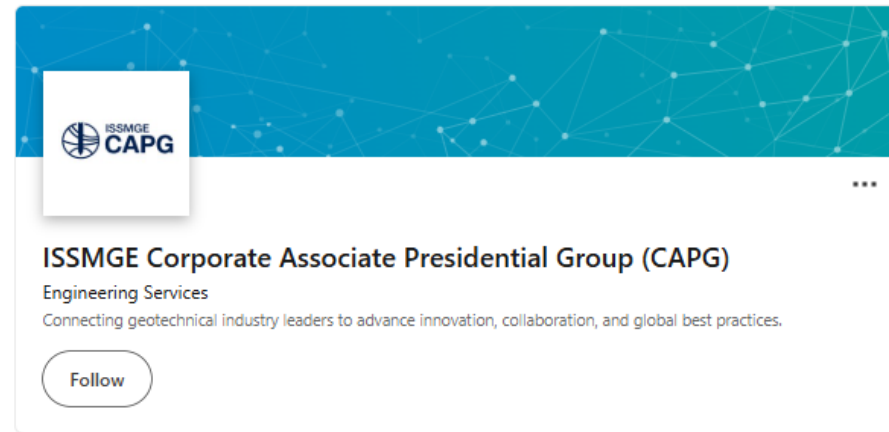

### About us

The Corporate Associate Presidential Group (CAPG) was founded in 2011 under the initiative of ISSMGE President Prof. Jean-Louis Briaud. Since its inception, CAPG has become the dedicated platform within ISSMGE that connects corporate associates, practitioners, and academics to advance geotechnical engineering worldwide. Our mission is to foster collaboration between industry and academia, promote technical excellence, and ensure the latest research is translated into practical applications that benefit infrastructure development and society. CAPG provides a unique forum where geotechnical professionals can share experiences, exchange knowledge, and highlight innovation in the field. What we do: - Organize panel discussions, workshops, and surveys on critical geotechnical issues (e.g., overdesign, sustainability, innovations). - Facilitate participation in international conferences and ISSMGE initiatives such as the Virtual Time Capsule and the Heritage Time Capsule. - Offer Corporate Associates the opportunity to present their expertise, showcase outstanding projects, and engage directly with global leaders in the profession. - Support technical platforms that drive innovation and address pressing challenges in geotechnical engineering. Member Benefits: - Visibility through ISSMGE's website, Bulletin, and Journal of Case History. - Opportunities to present and publish technical insights and project highlights. - Networking with leading experts, companies, and academics worldwide. - Active involvement in shaping the direction of the geotechnical industry. Our Vision: To strengthen the global geotechnical community by bridging the gap between research and practice, promoting innovation, and recognizing the valuable contributions of our members.

Website	<a href="https://www.issmge.org/corporate-associates/corporate-associates-presidential-group">https://www.issmge.org/corporate-associates/corporate-associates-presidential-group</a>
Industry	Engineering Services
Company size	51-200 employees
Type	Nonprofit

**CAPG @**



**PMGEC 2026 - Pan Mediterranean Geotechnical Engineering Conference - Lebanon**

CAPG @ [PMGEC 2026](#)  
Lebanon 2026  
25-28 March

**CAPG Members** are cordially invited to attend the **Pan Mediterranean Geotechnical Engineering Conference** that will take place in 📍 Beirut, Lebanon | 📅 March 25–28, 2026.

**BRIDGING BORDERS:  
GEOTECHNICAL CHALLENGES AND INNOVATIONS ACROSS THE  
MEDITERRANEAN**

Full conference details are available on **the Official Website:**

<https://pmgec-leb.com/>

**CAPG Members** are encouraged **to register early and** benefit from **the early bird rates!** Register & Save your spot: <https://pmgec-leb.com/lebanon/>

**We are looking forward to welcoming you to Beirut and to sharing what promises to be a spectacular and enriching conference together!**





# CAPG Marketing Campaign @ Register Online

*It has already started  
2 month ago and ongoing!*

## CAPG Marketing Campaign

We have launched the **CAPG Marketing Campaign** to expand the Corporate Associates community, through:

- Our CAPG website; [Corporate Associates Presidential Group | ISSMGE](#)
- Sharing the CA Members well defined benefits  [Discover Full Details & Exclusive Benefits](#)
- Notifying CA that Payment can be done online  [Register Online](#) or Corporate Associate can **scan the QR code below** to start the application process:





## CAPG Marketing Campaign

The **CAPG Marketing Campaign Launch** was done through multiple channels implemented across several channels:

- **National Societies:** Letters were sent to Geotechnical Societies requesting that they contact geotechnical companies in their regions—including consultants, designers, contractors, manufacturers, suppliers, and software developers—and invite them to join the ISSMGE Corporate Associates Presidential Group.
- **GeoWorld/GeoEngineer:** A similar invitation was circulated and broadcast to all geotechnical companies registered in the GeoWorld and/or GeoEngineer databases around mid December.
- **Online Channels:** Ongoing Invitations were shared through CAPG's LinkedIn page, the ISSMGE News page, and GeoWorld's News page.
- **Direct Contacts, Member Engagement:** One-on-one emails from CAPG team were sent to more than 200 companies, with outreach reaching over 600 individual contacts across these organizations during the week of 8–12 December 2025. Monitoring of traffic trends for the CAPG website from December 1 to January 5, with the page views shown in the next slides, explains the spike in views observed during this period. Reminders have been sent in mid-January 2026.
- Social Media (**LinkedIn**)

All Users Add comparison +

Custom Dec 1 - Dec 15, 2025 ▾

## Pages and screens: Page path and screen class ✓ ▾

Add filter +

Views by Page path and screen class over time

Day ▾

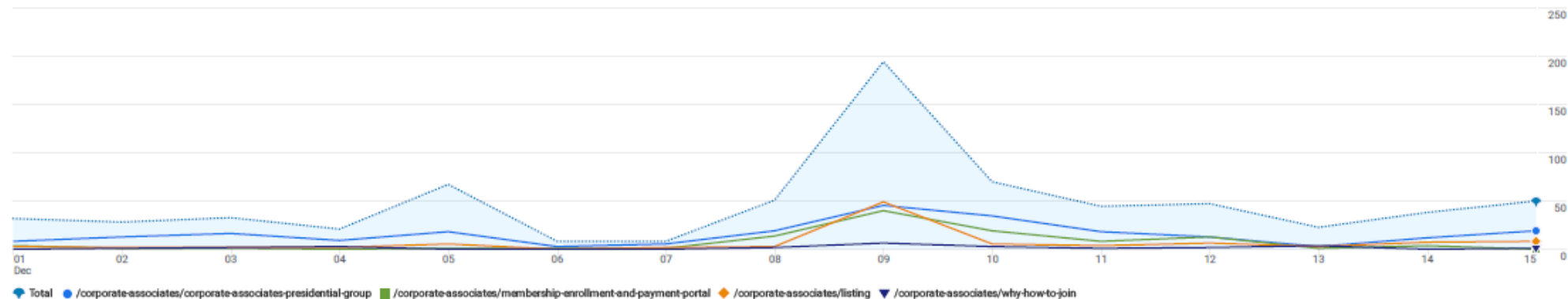

Plot rows		/corporate-associates		Rows per page: 10		Go to: 1		1-10 of 74	
	Page path and screen class ▾	Views	Active users	Views per active user	Average engagement time per active user	Event count	Key events	Total revenue	
		All events ▾	All events ▾			All events ▾	All events ▾		
<input checked="" type="checkbox"/>	Total	714 1.39% of total	374 1.14% of total	1.91 Avg +21.79%	37s Avg +110.32%	2,106 1.19% of total	0.00	\$0.00	
<input checked="" type="checkbox"/>	1 /corporate-associates/corporate-associates-presidential-group	235 (32.91%)	179 (47.86%)	1.31	27s	668 (31.72%)	0.00 (-)	\$0.00 (-)	
<input checked="" type="checkbox"/>	2 /corporate-associates/membership-enrollment-and-payment-portal	108 (15.13%)	90 (24.06%)	1.20	22s	359 (17.05%)	0.00 (-)	\$0.00 (-)	
<input checked="" type="checkbox"/>	3 /corporate-associates/listing	101 (14.15%)	52 (13.9%)	1.94	31s	253 (12.01%)	0.00 (-)	\$0.00 (-)	
<input checked="" type="checkbox"/>	4 /corporate-associates/why-how-to-join	25 (3.5%)	20 (5.35%)	1.25	15s	70 (3.32%)	0.00 (-)	\$0.00 (-)	
<input type="checkbox"/>	5 /corporate-associates/listing/sarathy-geotech	23 (3.22%)	10 (2.67%)	2.30	1m 05s	61 (2.9%)	0.00 (-)	\$0.00 (-)	
<input type="checkbox"/>	6 /corporate-associates/activities/meetings	20 (2.8%)	8 (2.14%)	2.50	25s	52 (2.47%)	0.00 (-)	\$0.00 (-)	
<input type="checkbox"/>	7 /corporate-associates/activities	16 (2.24%)	10 (2.67%)	1.60	10s	36 (1.71%)	0.00 (-)	\$0.00 (-)	
<input type="checkbox"/>	8 /corporate-associates/listing/giken	13 (1.82%)	6 (1.6%)	2.17	35s	22 (1.04%)	0.00 (-)	\$0.00 (-)	
<input type="checkbox"/>	9 /corporate-associates/activities/meetings/2025-11-26-capg-meeting	12 (1.68%)	4 (1.07%)	3.00	2m 30s	37 (1.76%)	0.00 (-)	\$0.00 (-)	
<input type="checkbox"/>	10 /corporate-associates/listing/geomil-equipment	12 (1.68%)	12 (3.21%)	1.00	21s	47 (2.23%)	0.00 (-)	\$0.00 (-)	

All Users Add comparison +

Custom Dec 15, 2025 - Jan 5, 2026

## Pages and screens: Page path and screen class

Add filter +

Views by Page path and screen class over time

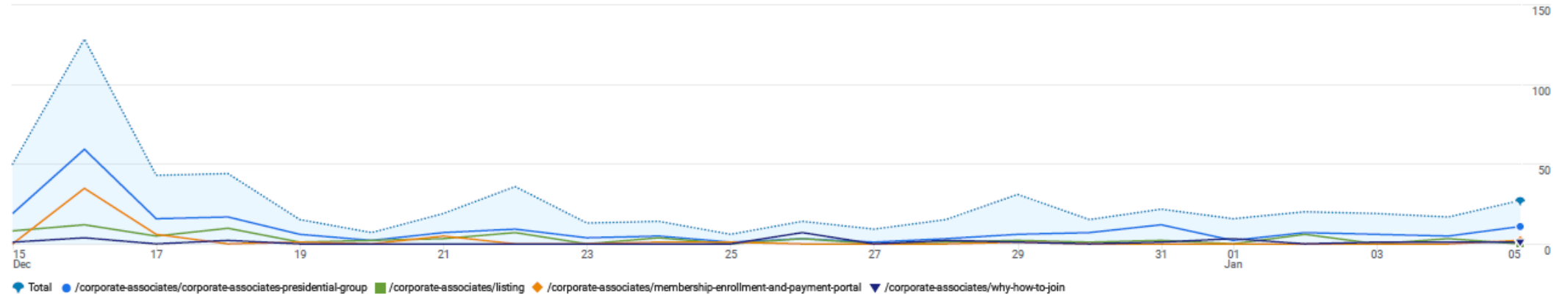

Plot rows

/corporate-associates

Rows per page: 10

Go to: 1

1-10 of 73

	Page path and screen class	Views	Active users	Views per active user	Average engagement time per active user	Event count	Key events	Total revenue
						All events	All events	
<input checked="" type="checkbox"/>	Total	580 0.88% of total	406 0.89% of total	1.43 Avg -1.71%	18s Avg +30.81%	1,759 0.83% of total	0.00	\$0.00
<input checked="" type="checkbox"/>	1 /corporate-associates/corporate-associates-presidential-group	208 (35.86%)	177 (43.6%)	1.18	16s	576 (32.75%)	0.00 (-)	\$0.00 (-)
<input checked="" type="checkbox"/>	2 /corporate-associates/listing	70 (12.07%)	46 (11.33%)	1.52	42s	179 (10.18%)	0.00 (-)	\$0.00 (-)
<input checked="" type="checkbox"/>	3 /corporate-associates/membership-enrollment-and-payment-portal	52 (8.97%)	47 (11.58%)	1.11	3s	167 (9.49%)	0.00 (-)	\$0.00 (-)
<input checked="" type="checkbox"/>	4 /corporate-associates/why-how-to-join	24 (4.14%)	19 (4.68%)	1.26	16s	66 (3.75%)	0.00 (-)	\$0.00 (-)
<input type="checkbox"/>	5 /corporate-associates/listing/dar	11 (1.9%)	11 (2.71%)	1.00	9s	40 (2.27%)	0.00 (-)	\$0.00 (-)
<input type="checkbox"/>	6 /corporate-associates/listing/ngi	10 (1.72%)	9 (2.22%)	1.11	9s	42 (2.39%)	0.00 (-)	\$0.00 (-)
<input type="checkbox"/>	7 /corporate-associates/listing/wagstaff-piling	8 (1.38%)	8 (1.97%)	1.00	2s	25 (1.42%)	0.00 (-)	\$0.00 (-)
<input type="checkbox"/>	8 /contributions/corporate-associates/uts	7 (1.21%)	6 (1.48%)	1.17	4s	24 (1.36%)	0.00 (-)	\$0.00 (-)
<input type="checkbox"/>	9 /corporate-associates/activities/meetings/2025-11-26-capg-meeting	7 (1.21%)	1 (0.25%)	7.00	1s	15 (0.85%)	0.00 (-)	\$0.00 (-)
<input type="checkbox"/>	10 /corporate-associates/capg/archives	7 (1.21%)	7 (1.72%)	1.00	0s	22 (1.25%)	0.00 (-)	\$0.00 (-)

CAPG Marketing  
Campaign  
GEOWORLD

International Society for Soil Mechanics and Geotechnical Engineering

Société Internationale de Mécanique des Sols et de la Géotechnique



**Join the ISSMGE Corporate  
Associates Presidential Group**

International Society for Soil Mechanics and  
Geotechnical Engineering

Société Internationale de Mécanique des  
Sols et de la Géotechnique



Dear Mr. Miller,

We are pleased to extend a personal invitation to your organization to join the [Corporate Associates Presidential Group \(CAPG\)](#) of the **International Society for Soil Mechanics and Geotechnical Engineering (ISSMGE)** — the world's premier platform for geotechnical professionals and industry leaders.

As a CAPG member, Corporate Associates gain:

- Global Visibility, by Showcasing their brand on an international stage.
- Direct Access, by Engaging with a network of top geotechnical experts, companies, and research and industry stakeholders.
- Industry Influence, by Participating in strategic discussions that shape the future of our field

With benefits ranging from enhanced promotion on ISSMGE platforms to the opportunity to highlight flagship projects, CAPG membership offers unparalleled value.

To join, the online process is simple:

 [Discover Full Details & Exclusive Benefits](#)

 [Register Online](#)

Alternatively, Corporate Associate can **scan the QR code below** to start the application process:



For those who prefer to secure their registration via bank transfer through their company's administration, please [Download CAPG Application Form](#), complete it, and submit the completed form directly to the Secretary General at [secretary.general@issmge.org](mailto:secretary.general@issmge.org)

**CAPG @ ICSMGE 2026 *Vienna***



## **CAPG Dedicated Session – [ICSMGE 2026 Vienna 2026](#)**

CAPG will host a dedicated **30-minute technical session** at [ICSMGE 2026 \(Vienna\)](#), highlighting **Outstanding Geotechnical Projects**.

### **Session Format**

- 5 selected project presentations (~5 minutes each)
- CAPG Chair introduction and overview

### **Current Status**

*Presentation Development Phase* **February 2026**

### **Confirmed Contributing Associations (CAs) & Projects**

1. **GDS** – Instrumented Bi-Directional Static Load Testing on Large-Diameter Hand-Dug Caissons using Distributed Fiber Optic Sensing
2. **HUESKER** – Geosynthetic-Encased Column System for the Second Niger River Bridge Project, Nigeria
3. **Menard & SRK** – Earing Tailings Dam Stabilisation Project
4. **UTS** – Tyre Cell Track Foundation System
5. **Tensar** – Geogrid-Stabilised Piling Platform Achieving 75% Carbon Reduction (Sustainability Theme)

### **Next Step**

Shortlisted projects invited to develop and submit detailed presentations for review and feedback.

### **Final Stage – ICSMGE 2026 (June)**

Live presentation of selected projects during the Vienna conference.

Additional high-quality submissions may be featured on the **CAPG section of the ISSMGE website**, extending visibility of CA contributions.

**CAPG**  
**contribution to the**  
**ISSMGE' Heritage Time Capsule (HTC)**  
**Vienna 2026**



- Sukumar is encouraging us to have more Virtual Time Capsule contributions by the CAs, so our contributions can be noted in the HTC report (currently under finalization),
- CAs can also consider putting forward proposals to donate physical objects for the Time Capsule that will be sealed in Vienna

**In Brief:**

CAPG 2026  
Resolutions

- Follow CAPG on LinkedIn
- Join us at the PMGEC (Lebanon!)
- Help us getting new CAPG Member
- Contribute to the HTC
- Do not forget to publish an Article or your Company commercial Add at the Bulletin!